

creating
new spaces



OPTIMAL



OPTIMAL POLAND:

Polish movable wall system.

We create a new space based on our own technology. We set safety, aesthetic and acoustic standards, in order to follow our customer needs. The company has been operating on the partition wall market since 2004 throughout the European Union and beyond. The walls of Optimal Poland are installed, among others in a hotel in French Polynesia - one of the most isolated places from Poland. Our walls shape the space in renowned hotels, offices, conference rooms, and public utility buildings. We provide safety, peace and comfort of work.

SUSTAINABLE DEVELOPMENT:

We are socially responsible. Sustainable development is part of our company's strategy. We cooperate with research units, we care for the local community. Our employees are our key capital. Our products are made with respect for the natural environment. We do not use bituminous mats in order to increase the acoustic insulation of our products. Optimal Poland walls are safe, in line with the company's strategy. This is the fundamental feature of our products.

POLISH MANUFACTURER:

Optimal Poland mobile walls are the most frequently chosen mobile wall systems in Poland. Light and automated walls allow for the optimal division of rooms. The system of mobile acoustic walls ensures the highest comfort of use (e.g. thanks to the possibility of automatic expansion of modules and high acoustic insulation).

We invite you to cooperate with us



movable
partition walls

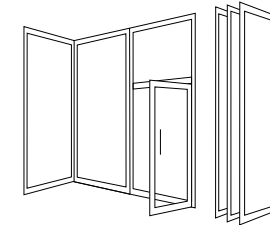
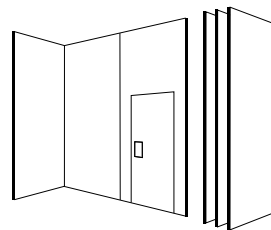
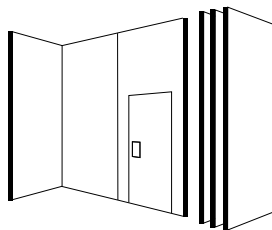
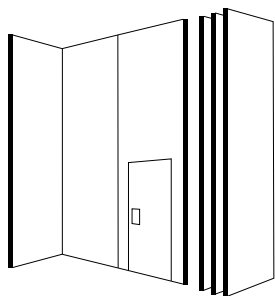

Rw	movable walls pp. 6-7		movable walls pp. 8-13		movable walls pp. 14-15		movable walls pp. 16-17	
57 dB	Optimal 110 sky plus	57 dB	Optimal 110 plus	57 dB				
54 dB	Optimal 110 sky plus	54 dB	Optimal 110 plus	54 dB				
53 dB	Optimal 110 sky plus alu	53 dB	Optimal 110 plus alu	53 dB				
52 dB			Optimal 110 plus fire  52 dB					
51 dB					Optimal 110	51 dB		
50 dB			Optimal 110 plus glass 50 dB					
49 dB					Optimal 110	49 dB		
45 dB					Optimal 110	45 dB		
33 dB							Optimal 50 glass	33 dB
32 dB							Optimal 50 light	32 dB

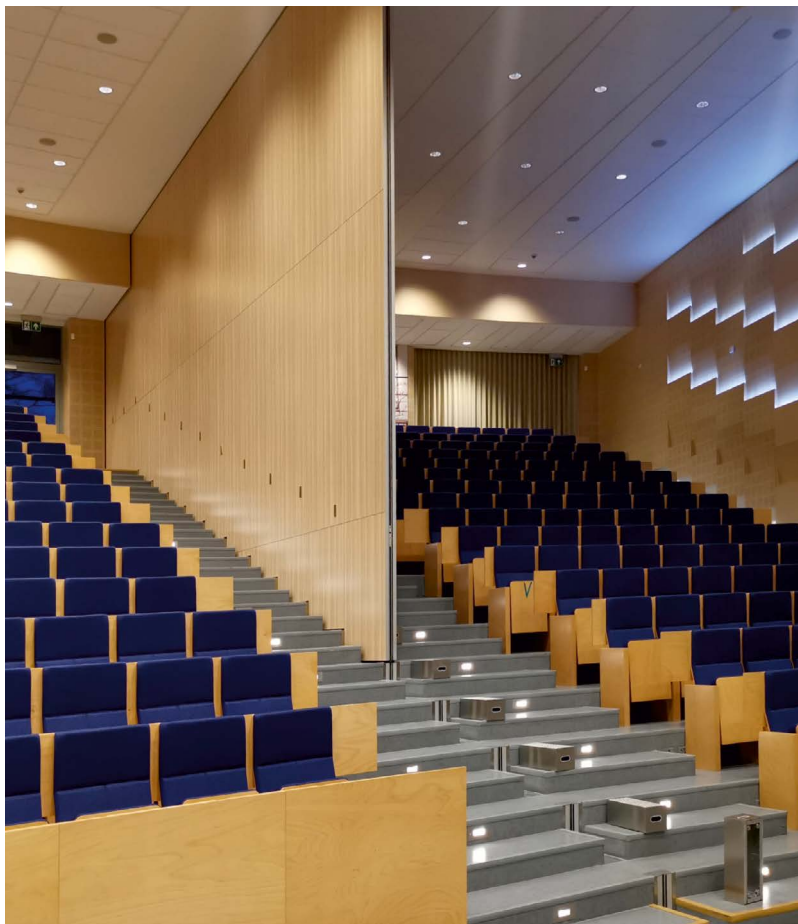

impressive
and safe

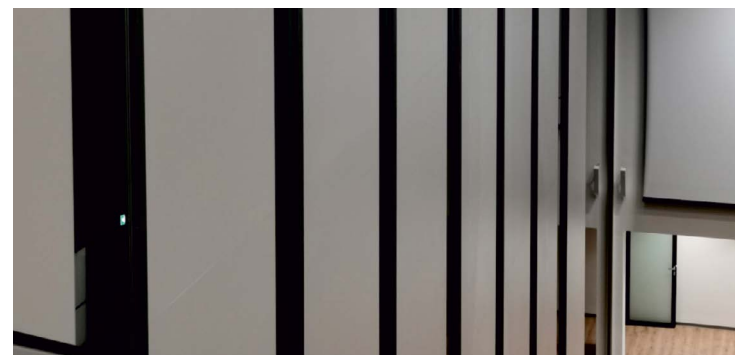

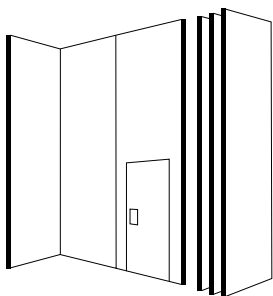

Optimal 110 sky / Optimal 110 sky plus / Optimal 110 sky plus alu

System of high movable walls which enables the division of very high rooms. The system has been tested for safety of use and mechanical strength which is confirmed by the construction sign . Our technology of building high movable walls offers a solution that in a simple way (manually or semi-automatically operated) allows the division of rooms such as lecture halls, sports halls, warehouses. Certified up to a height of 10850 mm.



ITB-KOT
2022/1699
Issue 1

Acoustic insulation:

Optimal 110 sky plus: $R_w = 57$ dB
Optimal 110 sky plus: $R_w = 54$ dB
Optimal 110 sky plus alu: $R_w = 53$ dB
Optimal 110 sky: $R_w = 45$ dB / 49 dB / 51 dB

Equipment options:

Single and double-leaf doors
Manual or semi-automatic operation

Fire reaction class:

D - s2, d0 / B - s1, d0 / B - s2, d0

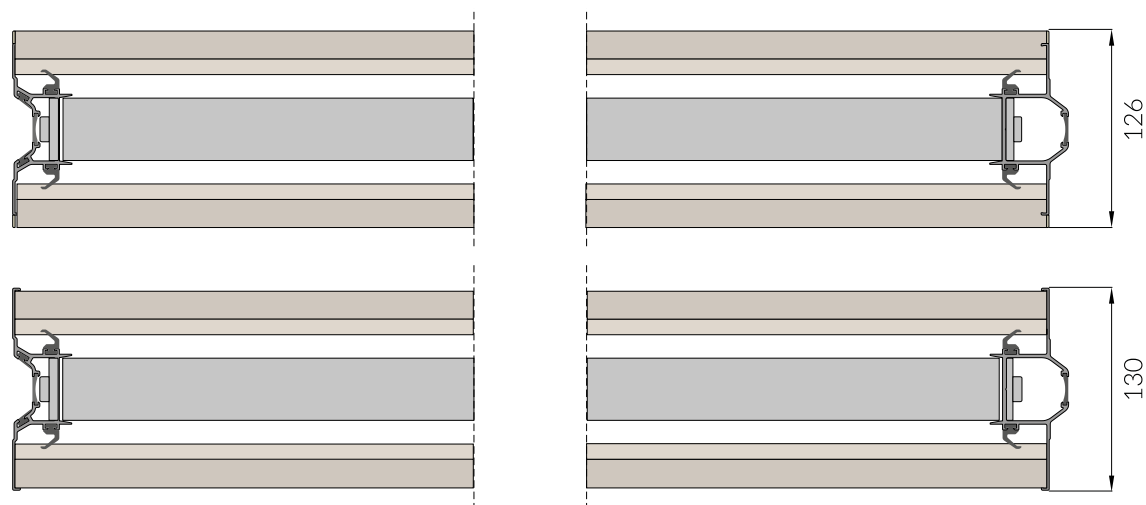

measurement >
design >
production >
installation >

R _w	movable walls
57 dB	Optimal 110 sky plus
54 dB	Optimal 110 sky plus
53 dB	Optimal 110 sky plus alu
52 dB	
51 dB	
50 dB	
49 dB	
45 dB	
33 dB	
32 dB	



appreciated
in Poland
and around
the world



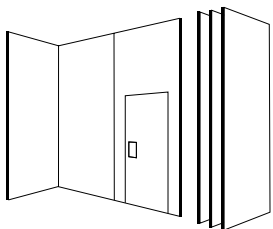

Optimal 110 plus and Optimal 110 plus alu

The most advanced system in terms of acoustic insulation parameters. The advantages of the system are its sound insulation properties at the level of $R_w = 54$ dB. The lack of visible vertical aluminium profiles in the Optimal 110 plus system creates additional arrangement possibilities. The visible vertical edges of the Optimal 110 plus alu system can be powder coated to any colour (RAL CLASSIC).

Acoustic insulation:

Optimal 110 plus: $R_w = 57$ dB

Optimal 110 plus: $R_w = 54$ dB

Optimal 110 plus alu: $R_w = 53$ dB

Equipment options:

Single and double-leaf doors

Manual or semi-automatic operation

Glazed modules ($R_w = 50$ dB)

Connecting mobile walls modules at different angles

Fire reaction class:

D-s2, d0 / B-s2, d0

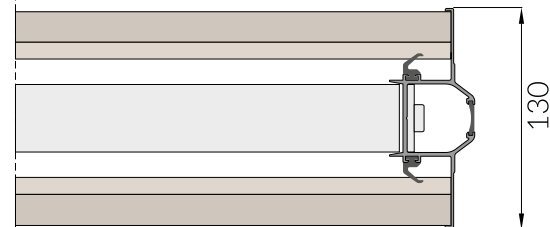
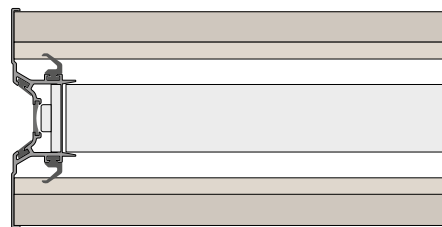
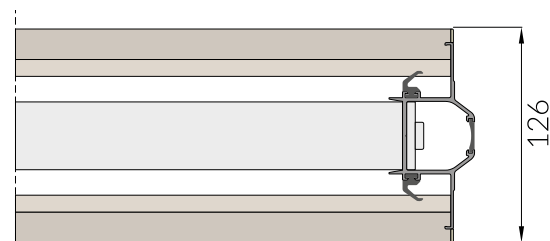
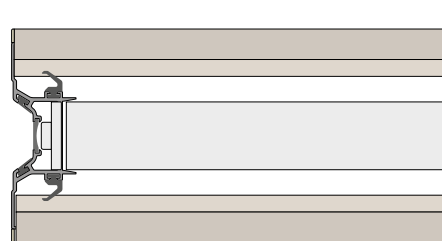

ITB-KOT
2022/1699
Issue 1

R _w	movable walls
57 dB	Optimal 110 sky plus
54 dB	Optimal 110 sky plus
53 dB	Optimal 110 sky plus alu
52 dB	
51 dB	
50 dB	
49 dB	
45 dB	
33 dB	
32 dB	

measurement >
design >
production >
installation >



secure
and subtle

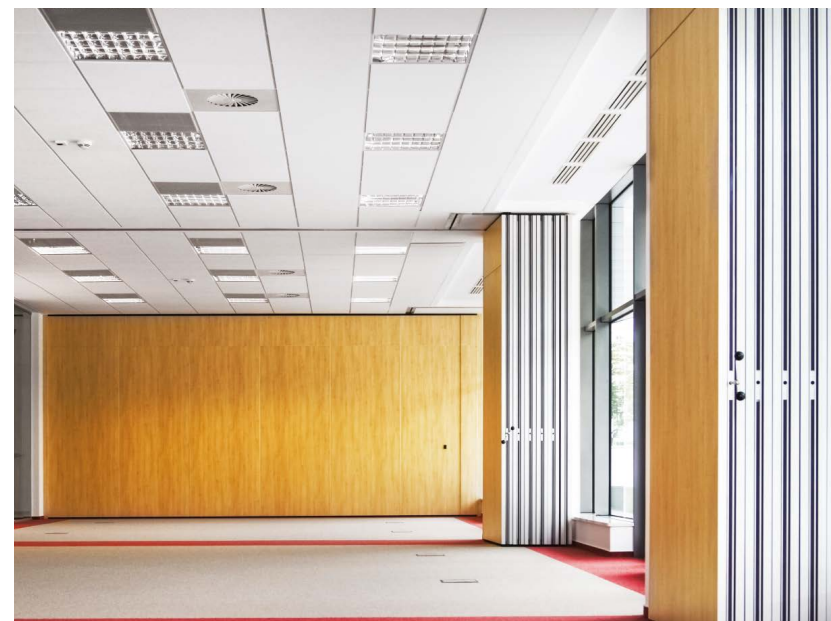

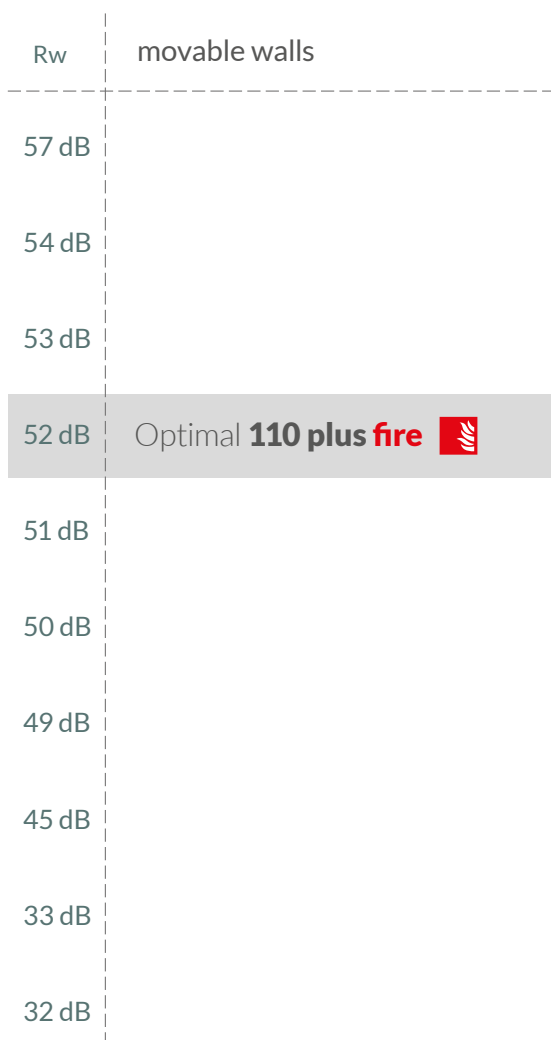
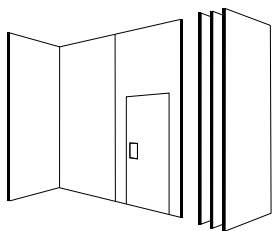

Optimal 110 plus fire

Safe system of fire rated movable walls. System with a thickness of 126 mm, without visible vertical aluminium profiles forming a uniform surface with fire resistance class EI30. Its maximum height is 4653 mm with unlimited length. Acoustic comfort is guaranteed by the Rw parameter of 52 dB. At the same time, full compatibility with the Optimal 110 Plus system is ensured.

Acoustic insulation:

Optimal 110 plus fire: Rw = 52 dB

Equipment options:

Single-leaf door
Manual or semi-automatic control

Fire reaction class:

B-s2, d0

Fire resistance:

EI30

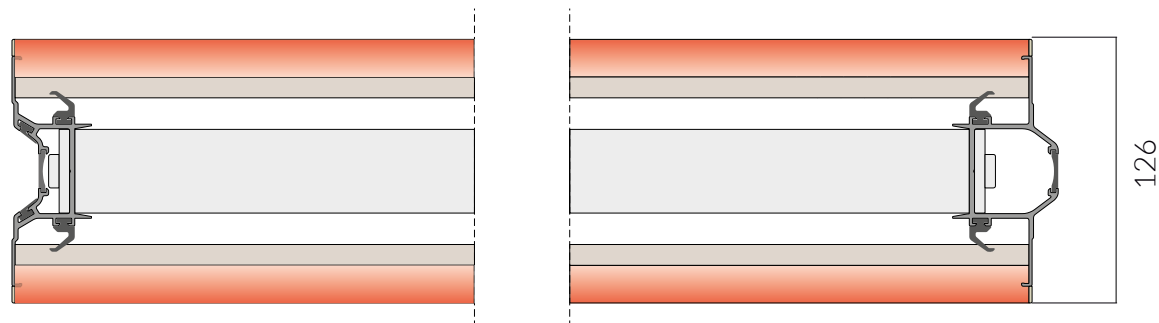

ITB -KOT
2022/1699
Issue 1

measurement >
design >
production >
installation >



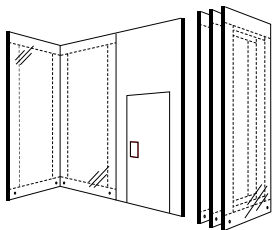

Optimal 110 plus glass

System of mobile walls finished with safety glass. Glass modules available in two options - with increased acoustic insulation at the level of $R_w = 50$ dB (with surface glass), and basic with glazing inside the module*. In both cases, glazed modules can be combined with full modules of appropriate Optimal 110 system family.

Acoustic insulation:

Optimal 110 plus glass: $R_w = 50$ dB

Equipment options:

Single and double-leaf doors (finished with a laminated panel)
Manual or semi-automatic control

R_w movable walls

57 dB

54 dB

53 dB

52 dB

51 dB

50 dB Optimal **110 plus glass**

49 dB

45 dB

33 dB

32 dB

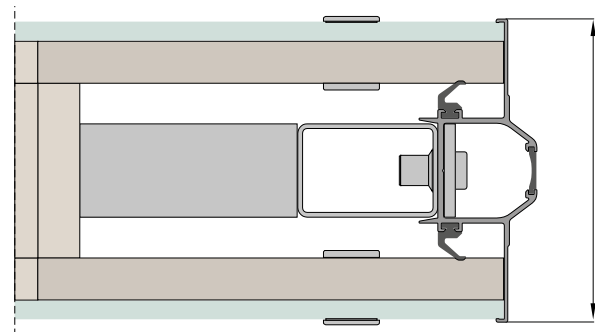
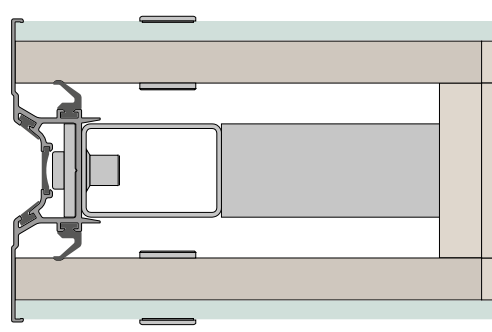

130

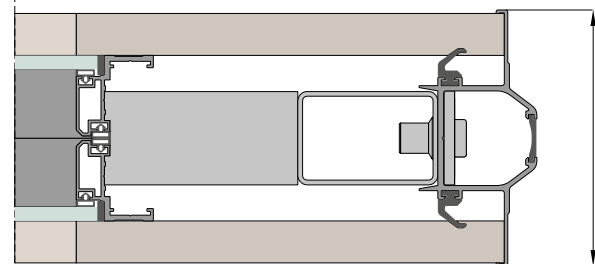
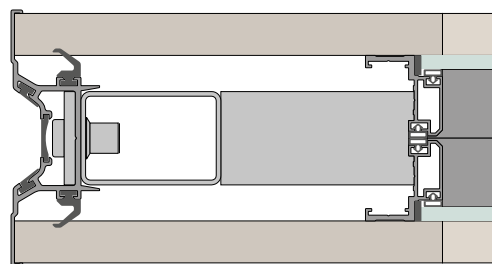

110

measurement >
design >
production >
installation >

* cross-section of the Optimal 110 glass module (page 15)



experience
and potential



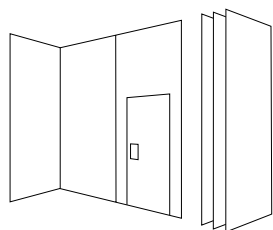

Optimal 110

A system of mobile walls with an extremely universal application and many configuration options. Sound insulation from $R_w = 45$ dB to $R_w = 51$ dB, possibility of using door modules and angular modules. Modules available in reaction to fire classes: D-s2, d0 or B-s1, d0 or B-s2, d0, and with impact resistance in class IVb, finished with laminated chipboard, or safety glass. Manual or semi-automatic operation. System is marked with the construction sign .

Acoustic insulation:

$R_w = 45$ dB / 49 dB / 51 dB

Equipment options:

Single and double-leaf doors
Manual or semi-automatic operation
Glazed modules
Connecting mobile walls modules at different angles

Fire reaction class:

D-s2, d0 / B-s1, d0 / B-s2, d0

Finishing options for the entire family of Optimal 110 systems:

mirror, whiteboard, modules prepared for wallpapering, HPL laminate, veneer

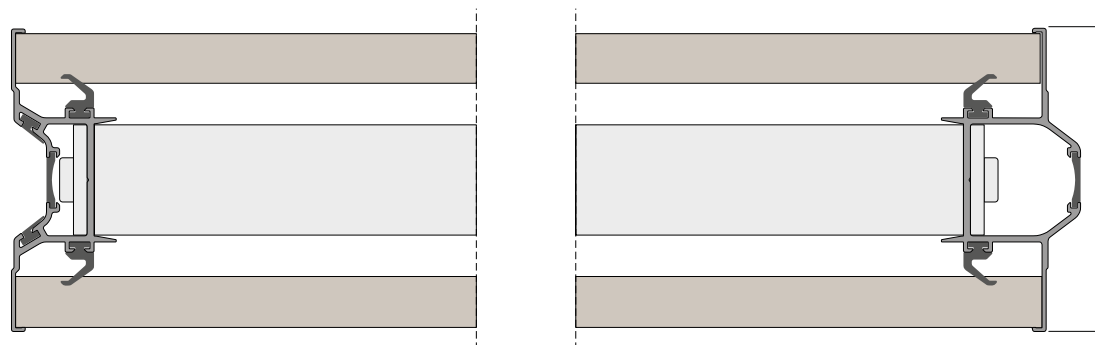

110

measurement >
design >
production >
installation >



ITB-KOT
2022/1699
Issue 1

R _w	movable walls
57 dB	
54 dB	
53 dB	
52 dB	
51 dB	Optimal 110
50 dB	
49 dB	Optimal 110
45 dB	Optimal 110
33 dB	
32 dB	



space
is our
specialty



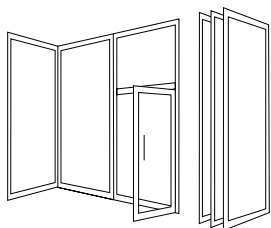

Optimal 50

An economical system for quick and aesthetic division of areas. Made of aluminium profiles filled with laminated chipboard or safety glass. The system offers a multitude of colour versions - from the basic version in a silver anode, to any colour from the RAL CLASSIC palette. By adding laminated panels, available in several dozen variants, and the possibility of a horizontal panel/glass division, we achieve, many possible combinations of finishing.

Acoustic insulation:

Rw = 32 dB – filled with laminated chipboard

Rw = 33 dB – filled with VSG safety glass

Equipment options:

Single-leaf door

Connecting mobile walls at 90° angle

Fire reaction class:

D-s2, d0 / B-s1, d0

Optional finishes:

mirror, whiteboard, frosted glass, translucent glass

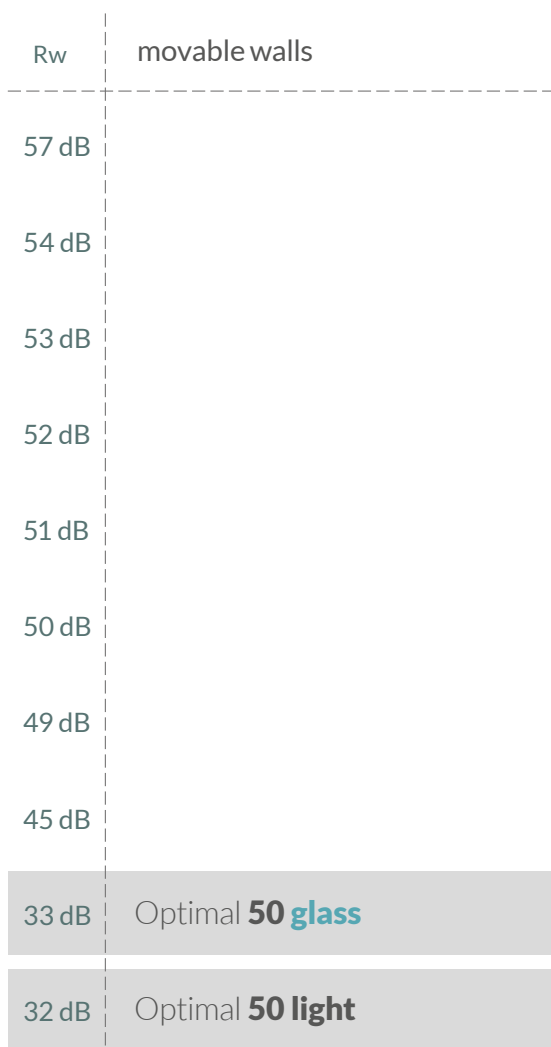

measurement >
 design >
 production >
 installation >

Standard modules of the Optimal 50 system

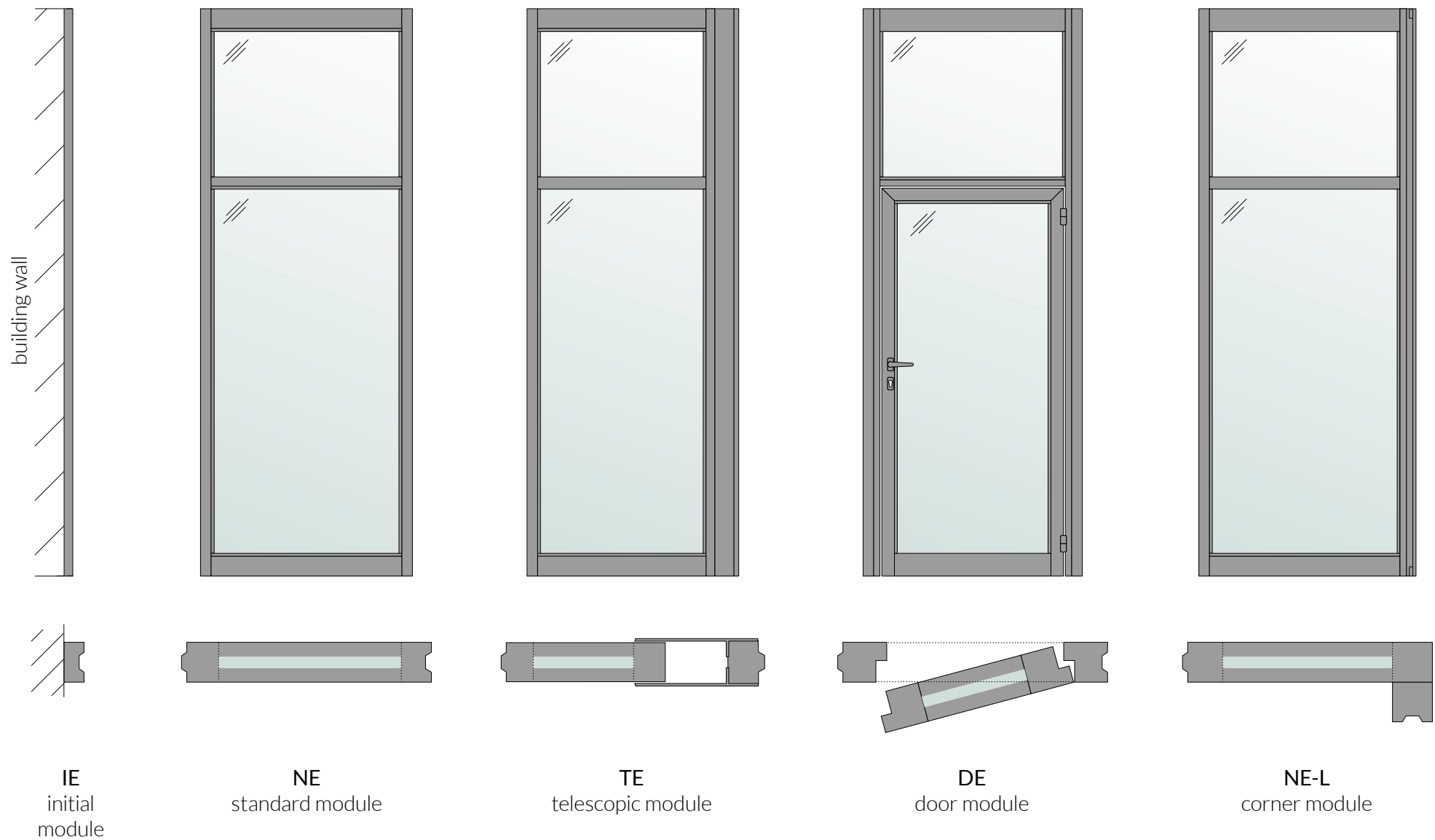

Standard modules of the Optimal 110 / Optimal 110 plus systems

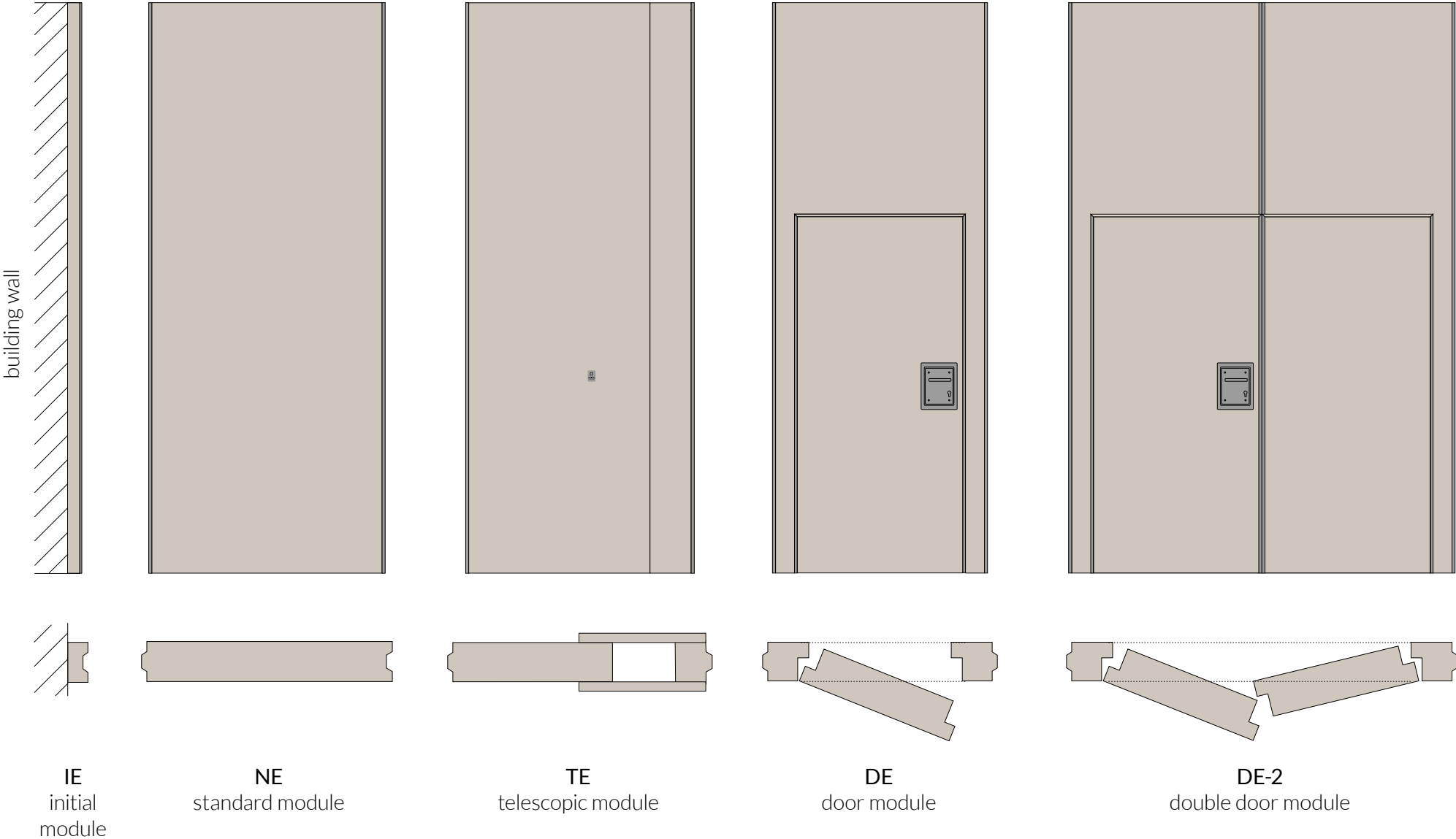

Standard modules of the Optimal 110 / Optimal 110 plus systems

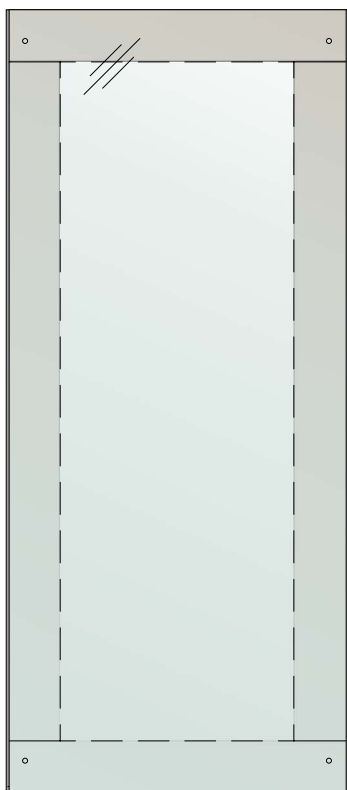

SE PLUS
glazed module
surface glass

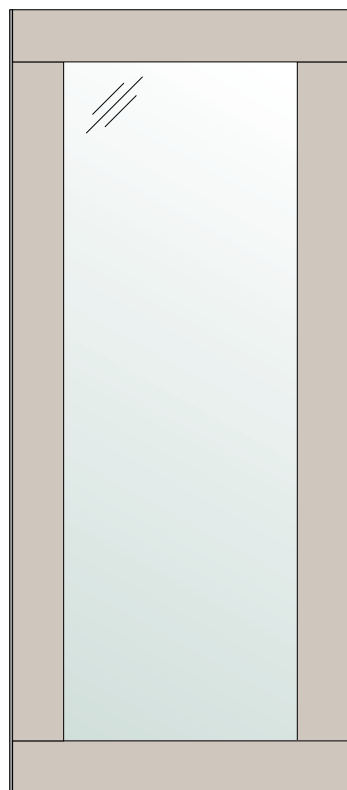

SE
glazed module
internal glass

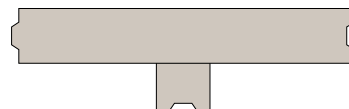
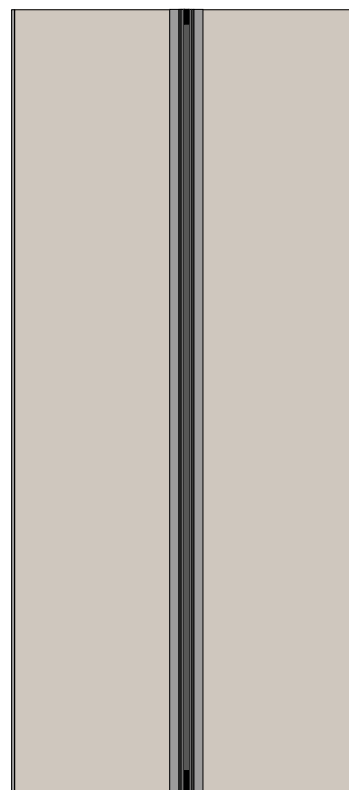

NE-T
angular module



NE-L
corner module

Movable wall installation

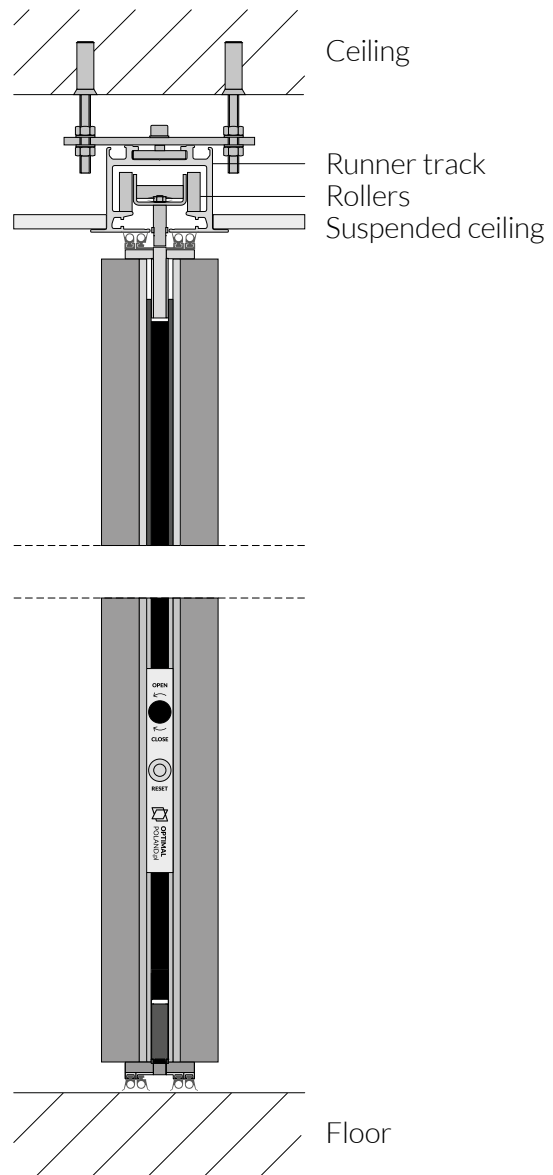

Movable wall parking options

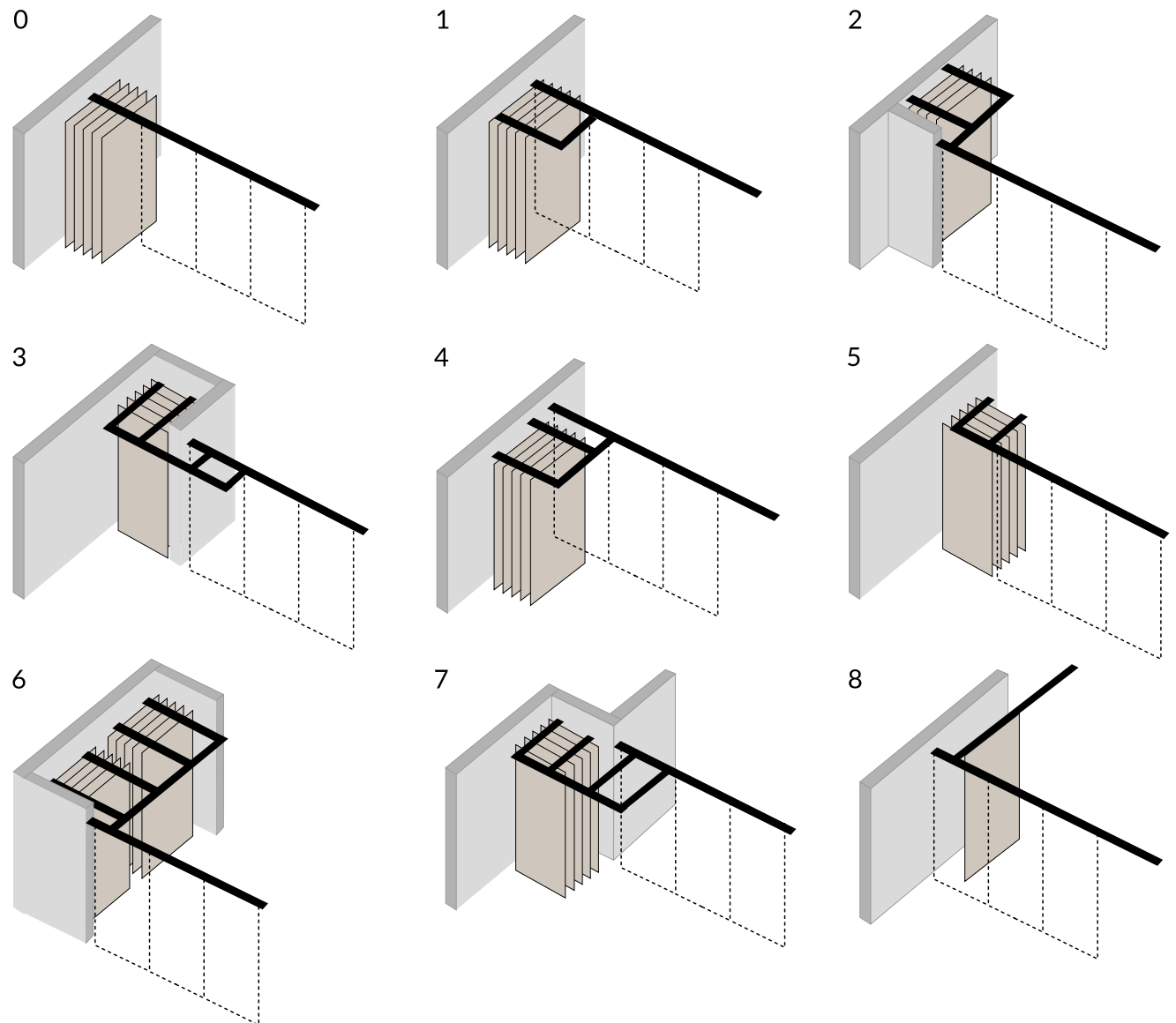



TESTS AND CERTIFICATES:

Our priority is to provide walls that are not only functional and aesthetic, but above all safe. In order to guarantee the highest level of safety of use, we constantly cooperate with certified laboratories of the Building Research Institute. As part of the research program, we checked our walls in terms of: fire resistance, sound insulation, safety of use, durability and usability, resistance to soft and heavy body impact, resistance to horizontal force, resistance to vertical static force and many others. In other words: we burned, pressed, hit with steel balls and heavy bags, hung huge loads, all in order to guarantee the highest level of safety and functionality. Evidence of the unprecedented nature of our activities includes conducting field research on the safe use of the Optimal 110 mobile wall, which is 10 850 mm tall.

ITB-KOT-2022/1699 National Technical Assessment (KOT)

It is a documented, positive assessment of the functional properties of the basic characteristics of a construction product, which, in accordance with the intended use, have an impact on the fulfilment of basic requirements by construction facilities in which the product will be used. The basic requirements are listed in Article 5 (1) (1) of the Act of July 7, 1994 - Construction Law (Journal of Laws of 2013, item 1409, as amended).

National Declaration of Performance (KDWU) and sign

Optimal 110 sliding walls, in accordance with ITB-KOT-2022/1699, are mass-produced products intended for general use. Movable walls Optimal 110, in accordance with ITB-KOT-2022/1699, are marked with the construction sign  and have the National Declaration of Performance (KDWU).



measurement >
design >
production >
installation >

Zakład Inżynierii Elementów Budowlanych
LABORATORIUM ELEMENTÓW BUDOWLANYCH

INSTITUT TECHNIKI BUDOWLANEJ
ZESPÓŁ LABORATORIÓW BADCZYCH
akredytowany przez Polskie Centrum Akredytacji
w 04-023

PCA
Polskie Centrum Akredytacji
04-023

Strona 1 z 48

RAPORT Z BADAŃ
NR LZE00-02722/19/200NZE

Niniejszy raport został wygenerowany w toku egzaminacji, przy czym dla otrzymanej Klasy, a jeden został w TB.

Niniejszy raport został wygenerowany w toku egzaminacji, przy czym dla otrzymanej Klasy, a jeden został w TB.

Informacje dotyczące obiektu badań

Klient: EUROPLAST Sławomir Wępiak
Adres Klienta: ul. Ławicze Drugi 107
20-258 Lublin 82

INFORMACJE DOTYCZĄCE WYROBU

Producent (nazwa i adres Firmy): EUROPLAST Sławomir Wępiak
ul. Ławicze Drugi 107
20-258 Lublin 82

Nazwa i adres Zakładu Produkcyjnego: EUROPLAST Sławomir Wępiak
ul. Ławicze Drugi 107
20-258 Lublin 82

Nazwa wyrobu: Zestaw wyrobów do wykonywania wewnętrznych nienodrzynnych modułowych szkieletów systemu OPTIMAL 110

Dokument odwołania dla wyrobu: ETAG 003

Informacja dotycząca wyrobu oraz deklarowanego zakresu stosowania i wyłączenia z niego systemu oceny i weryfikacji skuteczności oddziaływań:

Oznaczenie typu wyrobu budowlanego:

Informacje dotyczące obiektu badań

Opis, stan i identyfikacja:

Data przyjęcia obiektu badań:

Procedura przyjęcia obiektu badań:

Procedura przyjęcia obiektu badań:

INSTITUT TECHNIKI BUDOWLANEJ
ZESPÓŁ LABORATORIÓW BADCZYCH
akredytowany przez Polskie Centrum Akredytacji
w 04-023

PCA
Polskie Centrum Akredytacji
04-023

Strona 2 z 48

RAPORT Z BADAŃ NR LZF02-009171/18/200NZE

Niniejszy raport został wygenerowany w toku egzaminacji, przy czym dla otrzymanej Klasy, a jeden został w TB.

Informacje dotyczące wyrobu

Producent (nazwa i adres Firmy): Europlast Sławomir Wępiak
ul. Ławicze Drugi 107
20-258 Lublin

Nazwa i adres Zakładu Produkcyjnego: Europlast Sławomir Wępiak
ul. Ławicze Drugi 107
20-258 Lublin

Nazwa wyrobu: Dokument odwołania dla wyrobu

Informacja dotycząca wyrobu oraz deklarowanego zakresu stosowania i wyłączenia z niego systemu oceny i weryfikacji skuteczności oddziaływań:

Oznaczenie typu wyrobu budowlanego:

Informacje dotyczące obiektu badań

Opis, stan i identyfikacja:

Data przyjęcia obiektu badań:

Procedura przyjęcia obiektu badań:

Procedura przyjęcia obiektu badań:

INSTITUT TECHNIKI BUDOWLANEJ
ZESPÓŁ LABORATORIÓW BADCZYCH
akredytowany przez Polskie Centrum Akredytacji
w 04-023

PCA
Polskie Centrum Akredytacji
04-023

Strona 3 z 48

ŚWIADECTWO BADAŃ NR 02441/20/200NZE/2

Klient: EUROPLAST Sławomir Wępiak
ul. Ławicze Drugi 107
20-258 Lublin - Polska

Producent: EUROPLAST Sławomir Wępiak
ul. Ławicze Drugi 107
20-258 Lublin - Polska

Wyrób: OPTIMAL 110

System: Zestaw wyrobów do wykonywania wewnętrznych nienodrzynnych modułowych szkieletów systemu OPTIMAL 110

Konstrukcja: Konstrukcja zewnętrzna powłoki paneli białej (długości) wykonanej w technologii formowania wtryskowego z tworzywa sztucznego (polipropylen) z wypełnieniem pianką poliuretanową (PUF) o gęstości 30 kg/m³.

Moduł: Modułowa konstrukcja szkieletowa wykonana z tworzywa sztucznego (polipropylen) z wypełnieniem pianką poliuretanową (PUF) o gęstości 30 kg/m³.

Badawczo: Badania akustyczne i mechaniczne.

Informacje dotyczące obiektu badań

Opis, stan i identyfikacja:

Data przyjęcia obiektu badań:

Procedura przyjęcia obiektu badań:

Procedura przyjęcia obiektu badań:

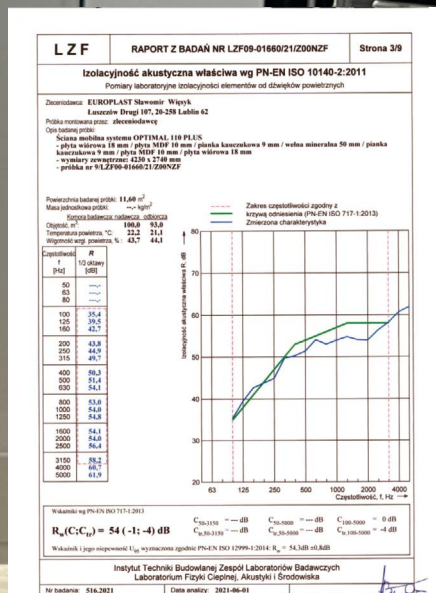
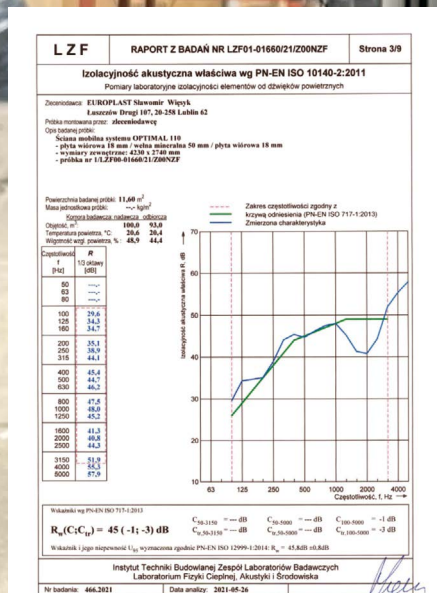







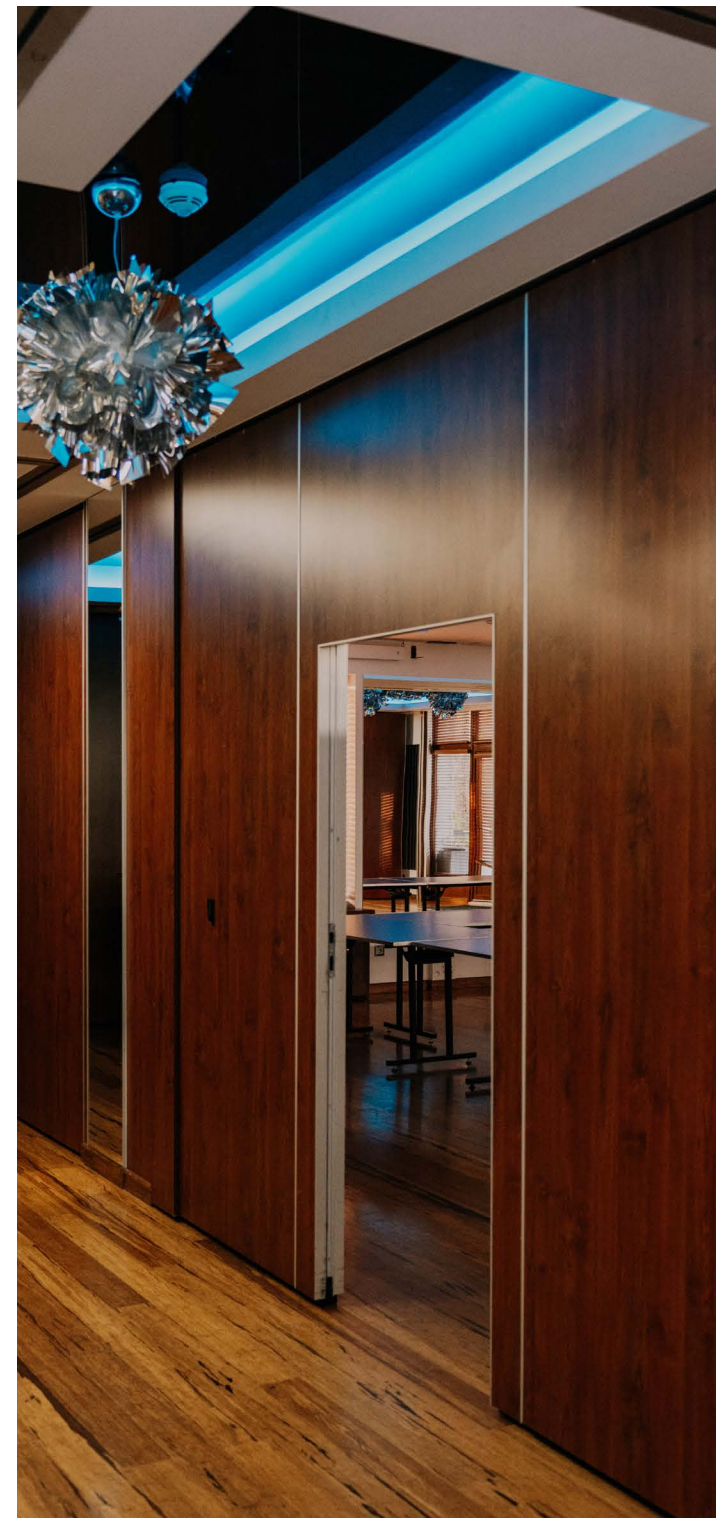

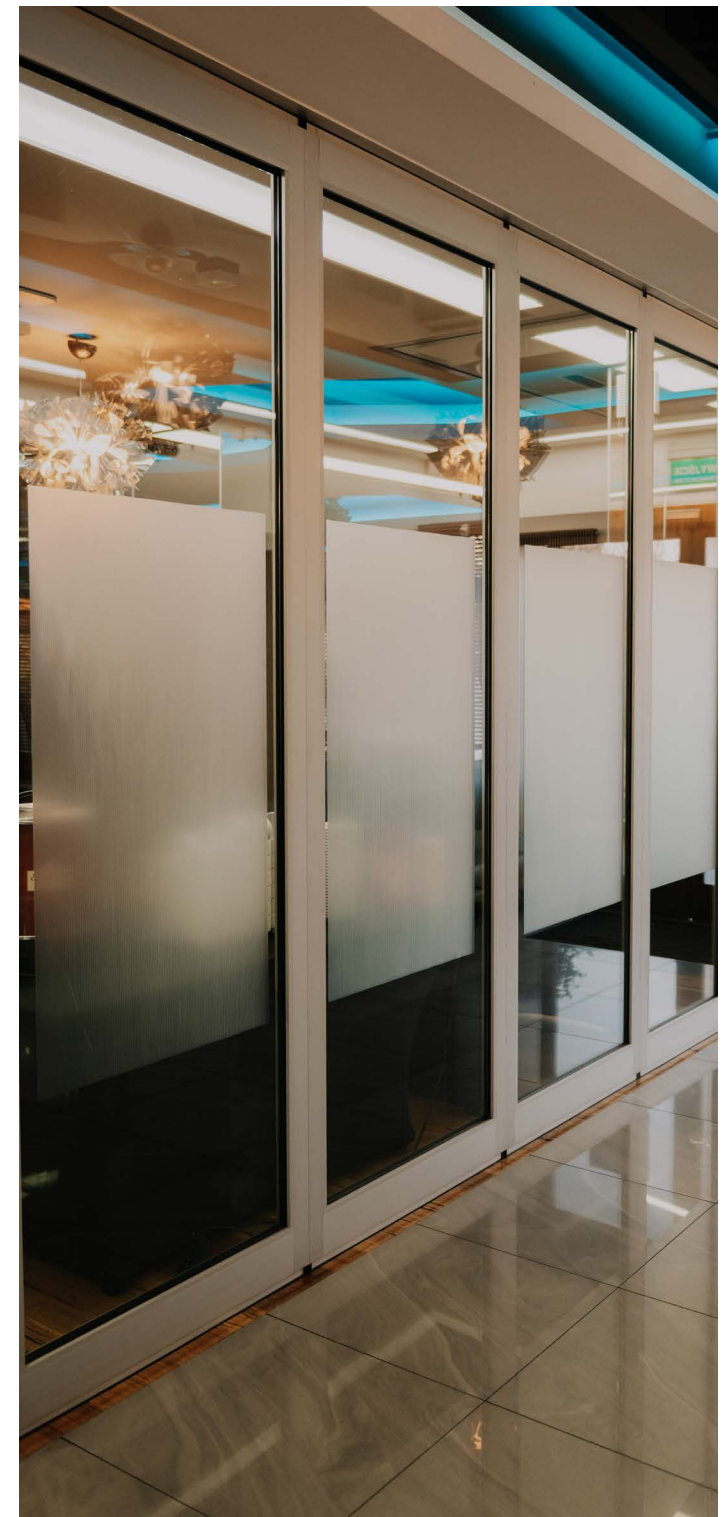



A modern interior space, likely a cafe or lounge, featuring wooden walls, a patterned rug, and various seating arrangements. The room is lit by warm pendant lights and has large windows on the left. A central pillar is visible. The background shows a service counter and a brick wall. The overall atmosphere is cozy and contemporary.

creating
new spaces





www.optimalpoland.pl
international@optimalpoland.com.pl
mobilne@optimalpoland.com.pl

+48 501 286 402